

DUMPER D 25 AC

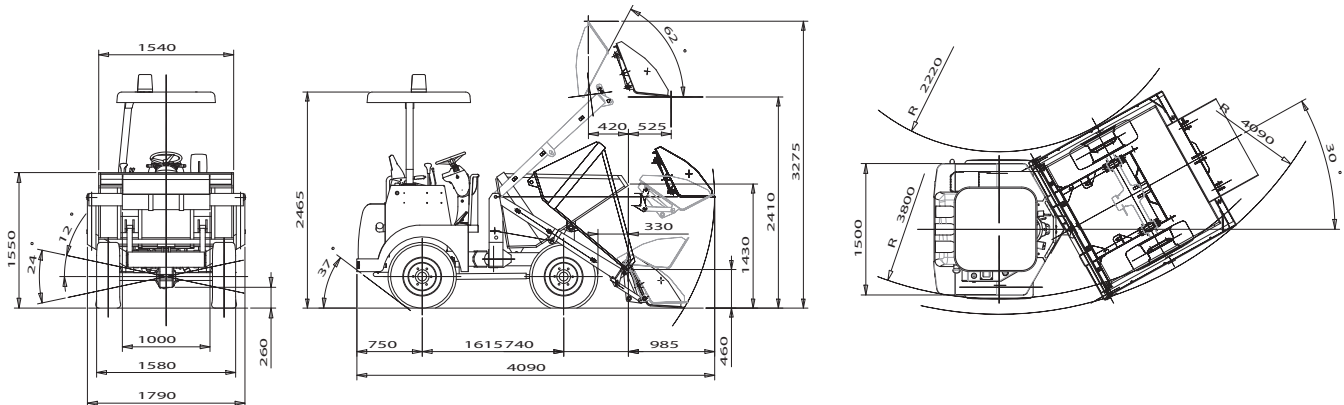

DIESEL ENGINE

Make and model YANMAR 3TNE82
 Rated power 22,2 kW (30 HP)@ 3000 rpm
 Torque, max 84.3 Nm No. of cylinders 3
 Total displacement 1331 cu.cm Direct injection
 Air filter with dry cartridge Water-cooled
 Conforms with exhaust emissions Directive
 97/68 CE and EPA regulations.

ELECTRICAL SYSTEM

Ignition motor 12V Alternator 12V - 15A Battery
 12V-100Ah (450A) Electrical starting and stop
 devices Cool starting device with termostating.

TYRES

Front and rear: 10.0/75-15.3

BRAKES

SERVICE: oil-bath disc brakes, housed inside the
 hubs, acting on all 4 wheels, fed by hydraulic
 independent brake pump. PARKING AND
 EMERGENCY: drum type on the front axle;
 mechanical lever controlled.

HYDRAULIC SYSTEM

Made up of dual hydraulic gear pump and distributor
 with lever and/or cloche control. Max
 payload: 35 l/min Max pressure: 150 bar
 Pressurized filtration system; the filter is
 replaceable from outside.

FOUR WHEEL DRIVE

Hydrostatic transmission with variable displacement
 pump and dual displacement hydraulic motor
 with electro-hydraulic control for "slow-fast-reverse"
 modes. Air-oil exchanger for hydraulic oil cooling.
 Speed
 1st: from 0 to 9 km/h
 2nd: from 0 to 20 km/h
 Traction/weight ratio: 40%

AXLES

Front: self-bearing, with planetary reduction gears
 on wheel-hubs. Rear: self-bearing, with planetary
 reduction gears on wheel hubs and block
 assembled transfer box in the differential housing.

STEERING

Hydrostatic fed by independent pump with steering-
 wheel control. Displacement 4,5 cu.cm/rev.
 Working pressure, max: 100 bar
 Controlled through steering cylinder acting on
 central articulation. Inside wheels min. steering
 radius: 2350 mm. Outside wheels min. steering
 radius: 3650 mm. Total steering radius: 60°
 (chassis articulation)

CHASSIS

Electro-welded steel structure, HEAVY DUTY
 articulation in central line with high resistance
 steel pressed dual pin. Total oscillation angle: 24°
 Hydraulic control of skip dumping By double-
 acting hydraulic cylinder. Loading bucket: made
 by an electrowelded tubular arm hinged to
 the front chassis through 2 standards acted by 2
 hydraulic cylinders. Shovel payload: 0,20 cu.m;
 hydraulic control of the geometry for
 loading and unloading.

DRIVER'S PLACE

Rational and ergonomic, easy access, central
 and elevated position, with excellent visibility.
 Anatomically designed seat with vertical and
 longitudinal regulation. ROPS-FOPS operator's
 canopy. Steering column with instrumentation
 dashboard and inclination adjustment of the
 steering wheel.

SERVICE CAPACITIES

Fuel (diesel): 30 litres
 Hydraulic oil: 48 litres
 Engine oil: 3,6 litres

WEIGHTS AND CAPACITIES

Weight in working conditions: 2270 kg
 Max skip payload: 2300 kg
 Skip capacity, struck: 1000 litres
 Skip capacity, heaped (SAE std): 1450 litres
 Self loading Skip capacity, struck: 110 litres
 Self loading Skip capacity, heaped (SAE std):
 170 litres

DIMENSIONS

Min. move length 4090 mm
 Max width 1790 mm

Max move height 2465 mm

Inside steering radius 2350 mm

Rear overhang angle 37°

Ground clearance (under differentials) 260 mm