

This is not a special ... these are our "everyday prices"

Castrol RX Super 20 litre

\$88.00 ea

Engine oil filter to suit 4-390 and 4T-390

\$10.12 ea

Outer air filter fits early 1840, 580K, 580SK

\$36.65 ea

Inner air filter fits early 1840, 580K, 580SK

\$25.13 ea

Fuel filter fits early 1840, 580K, 580SK

\$29.70 ea

Hydraulic filter fits early 1840, 580K, 580SK

\$66.00 ea

Exide 12v 86B 640CCA

\$126.50 ea

Britax Mag Base 12/24v plus in rotating beacon

\$95.70 ea

* Prices include GST

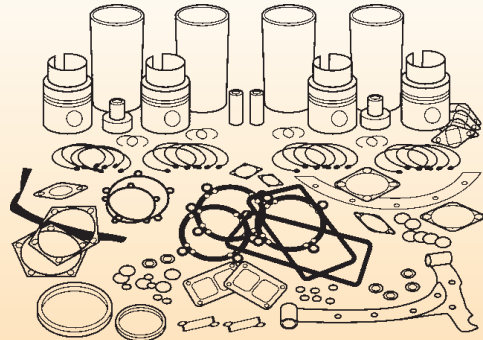

Semco

Equipment Sales

(Formerly Case Equipment Sales)

"Service through knowledge"

- Loader/backhoes
- Forklifts r/terrain
- Skidsteers
- Trenchers
- Crawler dozers
- Wheeled loaders
- Agricultural tractors
- Equipment insurance
- Road rollers/dump trucks
- Excavators
- Used equipment
- Equipment service
- Spare parts
- Service exchange
- Equipment finance
- Insurance repairs



Visa,
Mastercard,
Bankcard,
Direct
Deposit



Semco
Equipment Sales

The largest independent stockist of parts
to suit Case Construction machinery.

www.semco-group.com.au

Toll Free Phone 1800 640 103

Sydney on (02) 9833 6067 Newcastle on (02) 4954 7066

Queanbeyan on (02) 6297 2755